

EXEL HUMAN HEALTH CARE

Product Catalog



Certificates



FDA Registered Company

FDA 510(k) Registered Products

ISO & MDSAP Certified

We Private Label

Products Available In Bulk Packing By Inquiry



*The above certificates are subject to renewal and change.



CONTENTS

Insulin Syringes	1
Tuberculin Syringes	2
Allergy Syringes	2
Delivery Syringes	2
1mL Syringes	2
3mL Syringes	3
5-6mL Syringes	4
10-12mL Syringes	4
Curved Tip Syringes	4
20-25mL Syringes	5
30-35mL Syringes	5
50-60mL Syringes	5
Hypodermic Needles	6
Aluminum Hub Blunt Needles	6
Safety Hypodermic Needles	7
1mL Syringe with Safety Needle	8
3mL Syringe with Safety Needle	8
Vaculet Blood Collection Sets (Butterfly)	9
Safety Scalp Vein (Butterfly)	10
Scalp Vein (Butterfly) Sets	10
Bulk Non-Sterile Syringes	11
IV Administration Sets	12
IV Extension Sets	13
Safety Huber Infusion Sets Non DEHP	14
Huber Needles	14
IV Catheters	15
Multi-Sample Needles	16
Multi-Sample Luer Adapters	16
Multi-Sample Luer Holders	16
Multi-Sample Luer Lock Holders with Pre-Attached	16
Injection Plugs	16
Dental Needles	17
Spinal Needles	18
Surgical Blades	19
Disposable Scalpels	19
Pressure Bandages	20
Disposable Dermal Biopsy Punch	21
Disposable Dermal Curette	22
Product Specifications	23
Notes	24

INSULIN SYRINGES

Comfort point[®]



- ✓ This product does not contain Natural Rubber Latex
- ✓ Sterile
- ✓ Non-Toxic
- ✓ Non-Pyrogenic
- ✓ Permanently attached needle
- ✓ Reduced dead space for reduced Insulin waste
- ✓ Smooth plunger action for greater filling accuracy
- ✓ Auto ground needle tip for greater comfort



0.3mL LO-DOSE INSULIN SYRINGE

with permanently attached needle

Catalog No.	Description
26018	U-100 29G x 1/2"
26014	U-100 30G x 5/16"
26010	U-100 31G x 5/16"
10/bag 100/box 500/case	

1/2mL LO-DOSE INSULIN SYRINGE

with permanently attached needle

Catalog No.	Description
26026	U-100 28G x 1/2"
26028	U-100 29G x 1/2"
26015	U-100 30G x 5/16"
26011	U-100 31G x 5/16"
10/bag 100/box 500/case	

1mL INSULIN SYRINGE

with permanently attached needle

Catalog No.	Description
26027	U-100 28G x 1/2"
26029	U-100 29G x 1/2"
26016	U-100 30G x 5/16"
26012	U-100 31G x 5/16"
10/bag 100/box 500/case	

TUBERCULIN SYRINGES

ALLERGY SYRINGES

DELIVERY SYRINGE



1mL TUBERCULIN SYRINGE

with detachable needle, Luer-slip

Catalog No.	Description
26040*	1mL 27G x 1/2"
26042*	1mL 25G x 1"
26043*	1mL 26G x 1/2"
26044*	1mL 25G x 5/8"
26045*	1mL 26G x 3/8"

100/box 1,000/case

1mL TUBERCULIN SYRINGE ONLY

Catalog No.	Description
26048*	1mL Slip Tip with cap
26049*	1mL Lock Tip with cap
26050	1mL Lock Tip

100/box 1,000/case

1mL ZERO DEAD SPACE TUBERCULIN SYRINGE

with permanently attached needle

Catalog No.	Description
26046	1mL 25G x 5/8"

10/bag 100/box 500/case

SINGLE UNIT BLISTERS

Catalog No.	Description
26051	1mL 21Gx1"
26066	1mL 25Gx1"
26067	1mL 23Gx1"

100/box 1,000/case

1mL DELIVERY SYRINGE

Catalog No.	Description
OSTD1	1mL Delivery Syringe

10/pack 100/box 1000/case

1mL ALLERGY SYRINGE

with permanently attached needle

Catalog No.	Description
26061	1mL 27G x 1/2"
26063	1mL 27G x 3/8"

25/Tray 1000pc/Case

- ✓ This product does not contain Natural Rubber Latex
- ✓ Sterile, Non-Toxic
- ✓ Non-Pyrogenic
- ✓ Smooth plunger action for greater filling accuracy
- ✓ Auto ground needle tip for greater comfort
- ✓ Reduced dead space for reduced medication waste

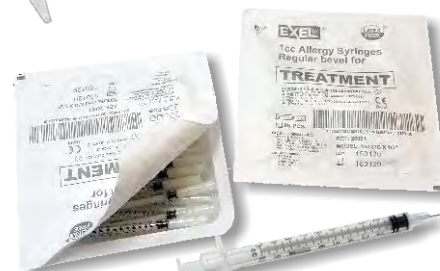
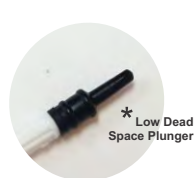

3mL SYRINGES



- ✓ This product does not contain Natural rubber latex
- ✓ Sterile
- ✓ Non-Toxic
- ✓ Non-Pyrogenic
- ✓ Low dead space

- ✓ Positive plunger stop to prevent spillage when drawing
- ✓ Smooth plunger motion
- ✓ Crystal clear barrels
- ✓ Easy to read, large bold print



3mL SYRINGE only	
Catalog No.	Description
26200	Luer Lock with cap
26201	Luer Slip with cap
100/box 1,000/case	

LUER-LOCK TIP			
3mL Syringe / Needle Combination			
Catalog No.	Description	Hub Color	
26100	25G x 5/8"	Orange	
26101	23G x 1"	Deep Blue	
26102	22G x 1"	Black	
26103	22G x 1 1/4"	Black	
26104	22G x 1 1/2"	Black	
26105	21G x 1"	Deep Green	
26107	21G x 1 1/2"	Deep Green	
26108	20G x 1"	Yellow	
26109	20G x 1 1/2"	Yellow	
26110	18G x 1 1/2"	Pink	
26111	25G x 1"	Orange	
26112	25G x 1 1/2"	Orange	
26115	22G x 3/4"	Black	
26117	23G x 1 1/2"	Deep Blue	
26129	27G x 1 1/4"	Medium Grey	
100/box 1,000/case			

LUER-SLIP TIP			
3mL Syringe / Needle Combination			
Catalog No.	Description	Hub Color	
26601	22G x 3/4"	Black	
26602	25G x 5/8"	Orange	
26603	23G x 1"	Deep Blue	
26605	22G x 1"	Black	
26608	21G x 1"	Deep Green	
26611	20G x 1"	Yellow	
100/box 1,000/case			

Syringes Available in trays



5-6mL SYRINGES 10-12mL SYRINGES CURVED TIP SYRINGES



- ✓ This product does not contain Natural Rubber Latex
- ✓ Sterile
- ✓ Non-Toxic
- ✓ Non-Pyrogenic
- ✓ With Cap

- ✓ Positive plunger stop to prevent spillage when drawing
- ✓ Smooth plunger motion
- ✓ Crystal Clear Barrels
- ✓ Easy to read large bold print



5-6mL SYRINGE/NEEDLE COMBINATION LUER-LOCK TIP

Catalog No.	Description	Hub Color
26210	22G x 1"	Black
26211	22G x 1½"	Black
26212	21G x 1"	Deep Green
26213	21G x 1½"	Deep Green
26214	20G x 1"	Yellow
26218	21G x 1¼"	Deep Green
26219	22G x 1¼"	Black

100/box 800/case

5-6mL SYRINGE only

Catalog No.	Description
26230	Luer Lock with cap
26231	Luer Slip with cap

100/box 800/case

10-12mL SYRINGE/NEEDLE COMBINATION LUER-LOCK TIP

Catalog No.	Description	Hub Color
26250	22G x 1"	Black
26251	22G x 1 ½"	Black
26252	21G x 1"	Deep Green
26253	21G x 1 ½"	Deep Green
26254	20G x 1"	Yellow
26255	20G x 1 ½"	Yellow
26257	18G x 1"	Pink

100/box 800/case

10-12mL SYRINGE only

Catalog No.	Description
26265	Luer Lock with cap
26266	Luer Slip with cap

100/box 800/case

CURVED TIP SYRINGE

Catalog No.	Description
26267	Curved Tip

50/box 500/case (non-sterile)

20-25mL SYRINGES

30-35mL SYRINGES

50-60mL SYRINGES



- ✓ This product does not contain Natural Rubber Latex
- ✓ Sterile
- ✓ Non-Toxic
- ✓ Non-Pyrogenic
- ✓ Easy to read large bold print

- ✓ Positive plunger stop to prevent spillage when drawing
- ✓ Smooth plunger motion
- ✓ Polypropylene construction
- ✓ Crystal Clear barrels

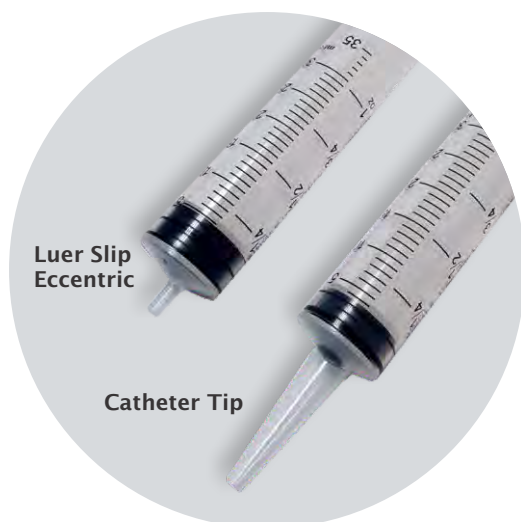

20-25mL SYRINGE only

Catalog No.	Description
26280	Luer Lock with cap
26281	Luer Slip Ecc with cap
50/box 500/case	

30-35mL SYRINGE only

Catalog No.	Description
26290	Luer Lock with cap
26291	Luer Slip Ecc with cap
26292	Cath Tip Ecc
50/box 250/case	

50-60mL SYRINGE only

Catalog No.	Description
26300	Luer Lock with cap
26301	Luer Slip Ecc with cap
26304	Catheter Tip with cap
25/box 150/case	

HYPODERMIC NEEDLES BLUNT NEEDLES

HYPODERMIC NEEDLE REGULAR BEVEL

Description	Catalog No.	Hub Color	
26400	27G x 1/2"	Medium Grey	■
26402	26G x 1/2"	Brown	■
26403	25G x 5/8"	Orange	■
26405	25G x 1"	Orange	■
26406	25G x 1 1/2"	Orange	■
26407	23G x 3/4"	Deep Blue	■
26408	23G x 1"	Deep Blue	■
26409	23G x 1 1/2"	Deep Blue	■
26410	22G x 3/4"	Black	■
26411	22G x 1"	Black	■
26412	22G x 1 1/2"	Black	■
26414	21G x 1"	Deep Green	■
26416	21G x 1 1/2"	Deep Green	■
26417	20G x 1"	Yellow	■
26418	20G x 1 1/2"	Yellow	■
26419	18G x 1"	Pink	■
26420	18G x 1 1/2"	Pink	■
26424	19G x 1"	Cream	■
26426	27G x 1 1/2"	Medium Grey	■
26427	27G x 1 1/4"	Medium Grey	■
26430	20G x 3/4"	Yellow	■
26431	20G x 1/2"	Yellow	■
26438	19G x 1 1/2"	Cream	■

100/box 2,000/case



ALUMINUM HUB BLUNT NEEDLES

Catalog No.	Description	Hub Colors	
26471	15G x 1 1/2"	Clear	□
26472	17G x 1 1/2"	Pale Green	■
26473	18G x 1"	Green	■
26474	19G x 1 1/2"	Lime	■
26475	20G x 1 1/2"	Pink	■

25/box, 100/case



- ✓ This product does not contain Natural Rubber Latex.
- ✓ Sterile, Non-Toxic, Non-Pyrogenic.
- ✓ SUS - 304 stainless steel.
- ✓ Needles and boxes are color-coded for easy identification.
- ✓ Each needle is individually packaged, sterilized and ready for use.



SPECIALTY USE HYPODERMIC NEEDLES

Catalog No.	Description	Hub Color	
26437	30G x 1/2"	Yellow	■
26439	30G x 1"	Yellow	■
100/box 2,000/case			
26448	28G x 3/4"	Blue Green	■
100/box 1,000/case			
26391	31G x 1/2"	Orange	■
26392	32G x 1/2"	Green	■
26392S	32G x 1/2"	Green(soft pack)	■
26393	33G x 1/2"	Clear	□
100/box 1,000/case			

NEEDLE LENGTH

Inches	1/2"	5/8"	3/4"	1"	1 1/4"	1 1/2"	2"
Millimeters	13mm	16mm	19mm	25mm	32mm	38mm	50mm



- ✓ This product does not contain natural rubber latex
- ✓ Sterile, single-use, individually packed blunt needle
- ✓ Stainless steel laser welded, non-lubricated cannula
- ✓ Aluminum hub, luer lock design
- ✓ Hub crimp cannula attachment
- ✓ Color - coded for easy identification
- ✓ 2-piece hard pack polypropylene needle cap and sheath

SAFETY HYPODERMIC NEEDLES

SecureTouch[®]

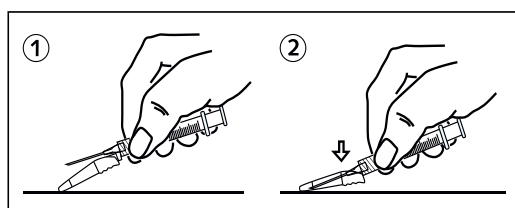
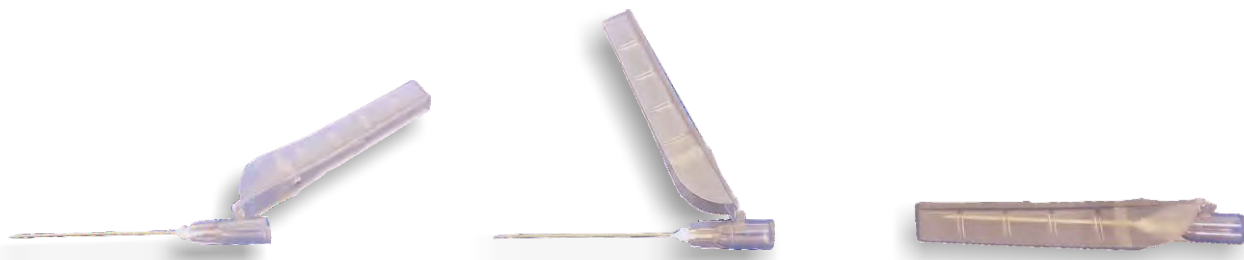

OR

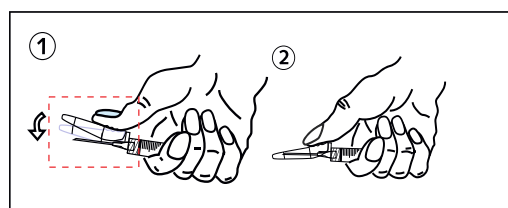

- ✓ This device does not contain natural rubber latex.
- ✓ Sterile, Non-Toxic, Non-Pyrogenic.
- ✓ One-Handed Activation
- ✓ No Solid surface required
- ✓ Simple finger stroke activation
- ✓ Protective arm keeps fingers behind the needle
- ✓ An audible “click” as well as tactile feel and a visual indicator confirm safety mechanism engagement
- ✓ Needle remains locked inside activated cover
- ✓ Fits any brand syringe.
- ✓ Safety shield can be pushed back comparative to the needle, allowing a clear view of the injection site.

SAFETY HYPODERMIC NEEDLES

Catalog No.	Description	Hub Color	
27403	25G x 5/8"	Orange	■
27405	25G x 1"	Orange	■
27406	25G x 1 1/2"	Orange	■
27408	23G x 1"	Deep Blue	■
27417	20G x 1"	Yellow	■
27420	18G x 1 1/2"	Pink	■
27426	27G x 1 1/2"	Medium Grey	■
27427	27G x 1 1/4"	Medium Grey	■
27437	30G x 1/2"	Yellow	■

100/box 1000/case

SYRINGE WITH SAFETY HYPODERMIC NEEDLES



- ✓ This product does not contain Natural Rubber Latex
- ✓ Sterile, Non-Toxic, Non-Pyrogenic.
- ✓ One-Handed Activation
- ✓ No Solid surface required
- ✓ Simple finger stroke activation
- ✓ Protective arm keeps fingers behind the needle
- ✓ An audible “click” as well as tactile feel and a visual indicator confirm safety mechanism engagement
- ✓ Needle remains locked inside activated cover
- ✓ Safety shield can be pushed back comparative to the needle, allowing a clear view of the injection site.

SecureTouch[®]

SYRINGE WITH SAFETY NEEDLE



3mL LL SYRINGE

Catalog No.	Description	Hub Color	Catalog No.	Description	Hub Color
27100	25G x 5/8"	Orange	27107	21G x 1 1/2"	Deep Green
27101	23G x 1"	Deep Blue	27108	20G x 1"	Yellow
27102	22G x 1"	Black	27110	18G x 1 1/2"	Pink
27104	22G x 1 1/2"	Black	27111	25G x 1"	Orange
27105	21G x 1"	Deep Green	27112	25G x 1 1/2"	Orange

50/box 400/case

- 1mL max dead space without needle 0.029mL (29µL)

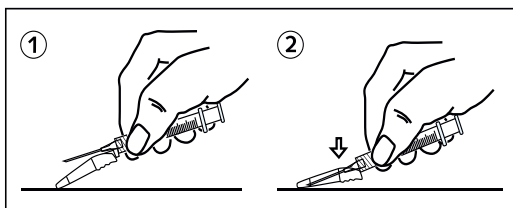

OR

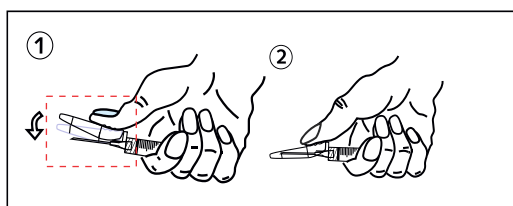

1mL LL SYRINGE

Catalog No. Description Hub Color

27042	25G X 1"	Orange
27044	25G X 5/8"	Orange
27047	23G X 1"	Deep Blue

50/box 300/case

27045	25G X 1"	Orange
27046	25G X 1 1/2"	Orange

100/box 2000/case

- 1mL max dead space without needle 0.019mL (19µL)



BLOOD COLLECTION SETS

SAFETY BLOOD COLLECTION SETS

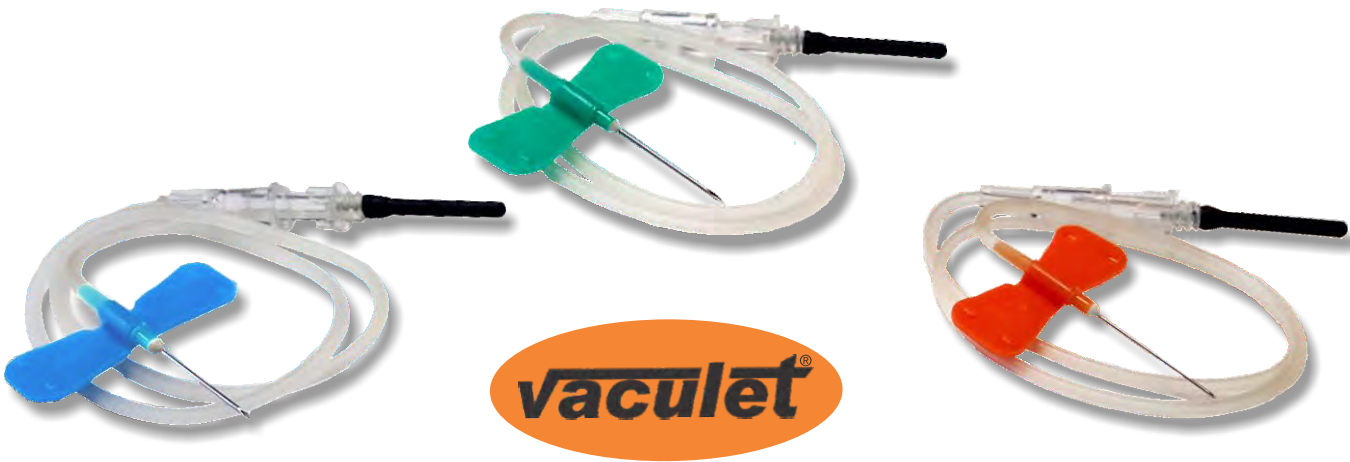

- ✓ This product does not contain Natural Rubber Latex.
- ✓ Sterile, Non-Toxic, Non-Pyrogenic.
- ✓ Individually packed.
- ✓ Flexible wings hold the needle in position and help to prevent inadvertent pull out.
- ✓ Color-coded for easier identification.
- ✓ Thin wall stainless steel cannula, siliconized for easy insertion.



BLOOD COLLECTION SETS			
Catalog No.	Description	Tube	Hub Color
26764	21G x 3/4"	12"	Green 
26766	23G x 3/4"	12"	Deep Blue 
26768	25G x 3/4"	12"	Orange 

50/box 200/case

SAFETY SCALP VEIN SETS

SCALP VEIN SETS



SecureTouch®



- ✓ This device does not contain natural rubber Latex
- ✓ Sterile, Non-Toxic, Non-Pyrogenic.
- ✓ Individually packaged
- ✓ Thin wall stainless steel cannula, siliconized for easy insertion
- ✓ Flexible wings hold the needle in position and help to prevent inadvertent pull out
- ✓ Color-coded for easier identification



Click & Lock

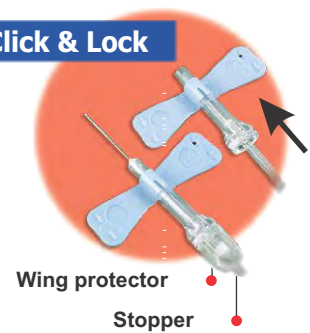

Wing protector
Stopper

SAFETY SCALP VEIN SET SAFETY PSV / BUTTERFLY / SMALL VEIN INFUSION

Catalog No.	Description	Tube	Hub Color
27704	21G x 3/4"	12"	Green
27706	23G x 3/4"	12"	Deep Blue
27708	25G x 3/4"	12"	Orange

*NON DEHP 50/box 500/case



SCALP VEIN SET PSV / BUTTERFLY / SMALL VEIN INFUSION

Catalog No.	Description	Tube	Hub Color
26702	19G x 3/4"	12"	Cream
26703	20G x 3/4"	12"	Yellow
26704	21G x 3/4"	12"	Green
26706	23G x 3/4"	12"	Deep Blue
26708	25G x 3/4"	12"	Orange
26709	27G x 3/4"	12"	Medium Grey

50/box 500/case

BULK NON-STERILE SYRINGES

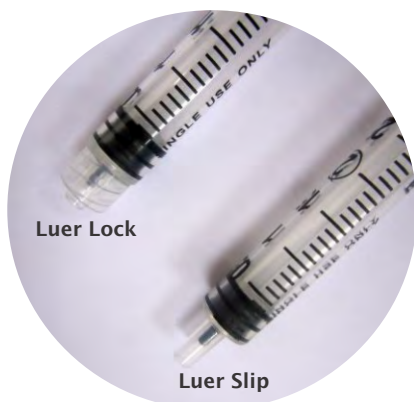

- ✓ This product does not contain Natural Rubber Latex
- ✓ With Cap
- ✓ Easy to read large bold print
- ✓ Positive plunger stop to prevent spillage when drawing
- ✓ Smooth plunger motion
- ✓ Crystal Clear Barrels

1mL BULK NS SYRINGE

Catalog No.	Description	Qty Per Case
*BN 26048	Luer Slip	4000
*BN 26049	TB Luer Lock	4000
BN 26050	TB Luer Lock	4000

3mL BULK NS SYRINGE

Catalog No.	Description	Qty Per Case
*BN 26200	Luer Lock	1500
*BN 26201	Luer Slip	1500

5-6mL BULK NS SYRINGE

Catalog No.	Description	Qty Per Case
BN 26230	Luer Lock	2000
BN 26231	Luer Slip	2000

10-12mL BULK NS SYRINGE

Catalog No.	Description	Qty Per Case
BN 26265	Luer Lock	1500
BN 26266	Luer Slip	1500

20-25mL BULK NS SYRINGE

Catalog No.	Description	Qty Per Case
BN 26280	Luer Lock	1000
BN 26281	Luer Slip	1000

Products packed in double bags

30-35mL BULK NS SYRINGE

Catalog No.	Description	Qty Per Case
BN 26290	Luer Lock	400
BN 26291	Luer Slip	400
BN 26292	Cath Tip	400

50-60mL BULK NS SYRINGE

Catalog No.	Description	Qty Per Case
BN 26300	Luer Lock	400
BN 26302	Cath Tip	400



100/per box, 4 box a case

Available in sterile and non-sterile, with printed barrel or non-printed barrel.
 ** Packaging is subject to change.

IV ADMINISTRATION SETS

FILTERED IV ADMINISTRATION SETS



- ✓ This product does not contain Natural Rubber Latex
- ✓ Sterile
- ✓ Non-Toxic
- ✓ Non-Pyrogen fluid path
- ✓ Occlusion clamp
- ✓ Pouch Packaging
- ✓ Vented/Non Vented
- ✓ Roller clamp

IV ADMINISTRATION SETS / VENTED / NON VENTED

With Y- Injection Site, Vented / Non vented, with Clamp • 78" Tubing

Priming Volume
23mL/Approx
Inside Diameter
3.0 ± 0.05mm
Outside Diameter
4.1 + 0.10 / -0.05

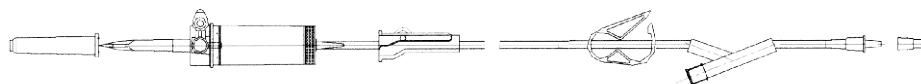

Catalog No. Description

29081 15 Drop/mL Luer slip
29083 60 Drop/mL Luer slip

50 pcs/case



Catalog No. Description

29082 15 Drop/mL Luer lock
29085 60 Drop/mL Luer lock

50 pcs/case

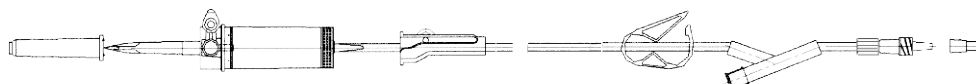

Catalog No. Description

29086 15 Drop/mL Lock/Slip
27086 15 Drop/mL Lock/Slip with Needle-Free Injection Site

50 pcs/case

With Y- Injection Site, Vented / Non vented, with Clamp • 105" Priming Volume Tubing

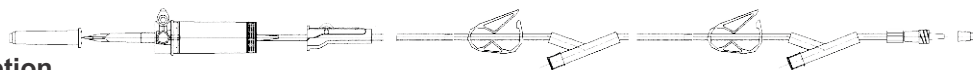

Catalog No. Description

29088 15 Drop/ml Lock/Slip, Vented/ Non vented, 2 Injection Sites, Roller Clamp, 2 Occlusion Clamps
28mL/Approx

50 pcs/case

FILTERED I.V. ADMINISTRATION SET VENTED / NON VENTED

Priming Volume
57mL/Approx
Inside Diameter
3.0 ± 0.05mm
Outside Diameter
4.2 + 0.05mm

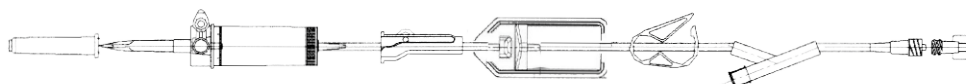

Catalog No. Description

26085 20 Drop/mL Luer Lock, Vented/Non vented, Latex Free Injection Sites,
Roller Clamp, Occlusion Clamps • 84" Tubing

50 pcs/case *NON DEHP

DEHP free tubing
0.2 Micron IV filter
Filter are constructed with materials that pass USP Class VI

IV EXTENSION SETS



- ✓ These devices do not contain natural rubber latex
- ✓ Sterile
- ✓ Non-Toxic
- ✓ Vented/Non -Vented
- ✓ Roller Clamp
- ✓ Occlusion Clamp

I.V. EXTENSION SETS

Catalog No.	Description	Qty	Priming Volume	I.D.	O.D.
1712	12" IV Extension Set with Luer Slip Connector, DEHP free	100pcs/cs	1.6mL	2.57	4
1720	20" IV Extension Set with Luer Slip Connector, DEHP free	100pcs/cs	2.5mL	2.57	4
1720WY	20" IV Extension Set with Luer Slip Connector, DEHP free with Injection Site	100pcs/cs	2.5mL	2.57	4
1730	30" IV Extension Set with Luer Slip Connector, DEHP free	100pcs/cs	3.6mL	2.52	4
1730WY	30" IV Extension Set with Luer Slip Connector DEHP free with Injection Site	100pcs/cs	3.6mL	2.52	4
1772	72" Universal IV Administration Set with Luer Lock Connector DEHP free	60pcs/cs	2.8mL	1.4	2.5

Tolerances

Inside Diameter $0 \pm 0.05\text{mm}$

Outside Diameter $0.05 \pm 0.15\text{mm}$

SAFETY HUBER INFUSION SETS

HUBER NEEDLES



- ✓ This device does not contain natural rubber latex
- ✓ Sterile, Non-Toxic, Non-Pyrogenic.
- ✓ Easy to Use
- ✓ Easy to Dress
- ✓ Ultra Low Profile
- ✓ Small Footprint
- ✓ Angled Tuning

Patient Safety & Comfort

- Minimizes damage to port septum
- Significantly reduces penetration and access forces
- Designed for patient comfort
- Easy-to-dress
- Helps maintain dressing integrity
- Non-DEHP

Safety Features

- Built-in Safety Mechanism
- Smooth, Light Lockout
- Ergonomic, Integral Wing Design
- Audible "Click", Tactile Feel and visual indication of Lockout
- Needle Forward Design

Benefits

- Complies with OSHA standards
- Reduces the risk of needle stick injury
- Controlled, easy safety mechanism engagement
- Controlled, secure access
- Confirms safety mechanism activation
- Facilitates dual lumen port access
- Easy to view needle and site during access

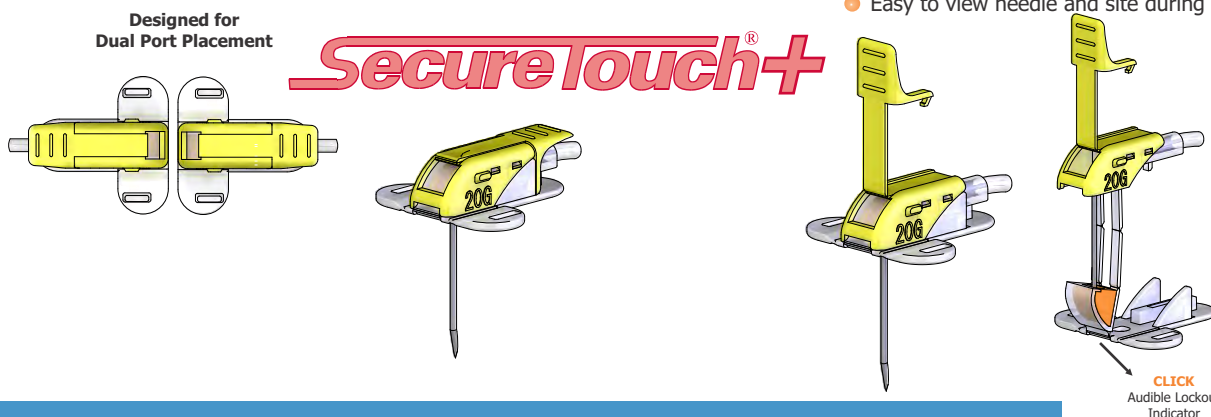

SECURE TOUCH+ SAFETY HUBER INFUSION SET

7" tube, 'Y' injection site (right angle)

Catalog No.	Description	Hub Color
37840S	19G x 1"	Cream
37841S	19G x 3/4"	Cream
37844S	20G x 1"	Yellow
37845S	20G x 3/4"	Yellow
37846S	20G x 1 1/2"	Yellow
37848S	22G x 1"	Black
37849S	22G x 3/4"	Black
37850S	22G x 1 1/2"	Black

20 / box

7" tube (right angle)

Catalog No.	Description	Hub Color
37854S	20G x 1"	Yellow
37855S	20G x 3/4"	Yellow
37856S	20G x 1 1/2"	Yellow
37858S	22G x 1"	Black
37859S	22G x 3/4"	Black

20 / box

HUBER NEEDLES

(non-coring) straight

Catalog No.	Description	Hub Color
26920	20G x 2"	Yellow

50 / box



- ✓ This device does not contain natural rubber latex
- ✓ Sterile, Non-Toxic, Non-Pyrogenic.
- ✓ NON-DEHP
- ✓ Non-Coring
- ✓ 316L stainless steel construction
- ✓ Color-coded according to gauge for easy identification

SAFELET IV CATHETERS



- ✓ This device does not contain natural rubber latex
- ✓ Sterile, Non-Toxic, Non-Pyrogenic.
- ✓ Functional design casing permitting one action opening and no rolling
- ✓ Color-coded casing cap allows for easier identification of catheter size
- ✓ Translucent catheter hub and flashback chamber allows for easy detection of blood flashback at vein insertion
- ✓ Precision finished FEP catheter assures stable flow and eliminates catheter tip kink during venipuncture
- ✓ Easy dispenser pack
- ✓ Radio-opaque catheter
- ✓ Cannula with additional back bevel
- ✓ Can be connected to syringe by removing filter cap to expose Luer taper end
- ✓ Use of hydrophobic membrane filter eliminates blood leakage
- ✓ Close and smooth contact between catheter tip and inner needle enables safe and smooth venipuncture
- ✓ Crimped smooth engagement between catheter and hub, without use of adhesive, helps eliminate blood residuals and helps reduce blood coagulation or hemolysis

IV CATHETERS

Stainless Cannula

Item No.	Size	Gauge	Outside Diameter (mm)	Total Length (mm)	Hub Color	
26726	14G x 1¼"	14G	1.63	51.0	Orange	■
26729	14G x 2"	14G	1.63	67.0	Orange	■
26730	16G x 1¼"	16G	1.2	50.0	Medium Grey	■
26731	16G x 2"	16G	1.2	66.0	Medium Grey	■
26735	18G x 1¼"	18G	0.9	47.0	Green	■
26736	18G x 1½"	18G	0.9	54.0	Green	■
26738	18G x 2"	18G	0.9	66.0	Green	■
26741	20G x 1"	20G	0.71	41.0	Pink	■
26742	20G x 1¼"	20G	0.71	48.0	Pink	■
26743	20G x 2"	20G	0.71	66.0	Pink	■
26746	22G x 1"	22G	0.56	40.0	Blue	■
26751	24G x ¾"	24G	0.41	34.0	Yellow	■

50/box 200/case

MULTI-SAMPLE NEEDLES

MULTI-SAMPLE LUER ADAPTERS

MULTI-SAMPLE LUER HOLDERS

INJECTION PLUG



- ✓ This product does not contain Natural Rubber Latex
- ✓ Sterile
- ✓ Non-Toxic
- ✓ Non-Pyrogenic.

- ✓ Multi-sample needle permit several samples to be taken with a single puncture
- ✓ Sharp & smooth edges make penetration painless for patients and provides easy connection to rubber stoppers

MULTI-SAMPLE (BLOOD DRAW) NEEDLES

Catalog No.	Description	Hub Color
26500	18G x 1"	Pink
26501	20G x 1"	Yellow
26502	20G x 1½"	Yellow
26503	21G x 1"	Deep Green
26504	21G x 1½"	Deep Green
26505	22G x 1"	Black
26506	22G x 1½"	Black

100/box 1,000/case

MULTI-SAMPLE LUER ADAPTERS

Catalog No.	Description
26537	Luer Adapter

100/bag 1,000/case

MULTI-SAMPLE LUER HOLDERS

Catalog No.	Description
26530	5-7.5mL Holder

100/bag 1,000/case (non-sterile)

MULTI-SAMPLE HOLDER W / PRE-ATTACHED LUER ADAPTERS

Catalog No.	Description
26532	5-7.5mL Holder w / adapter

50pcs/box 200/case (sterile)

Catalog No.	Description
BN 26532	5-7.5mL Holder w / adapter

150/bag 1,500/case (bulk, non-sterile)

INJECTION PLUG

Catalog No.	Description
26539	Injection Plug with cap LL

*Not for use with needles larger than 18 gauge.

50/box 200/case (sterile)



DENTAL NEEDLES



- ✓ This product does not contain Natural Rubber Latex
- ✓ Sterile, Non Toxic, Non-Pyrogenic
- ✓ New hub design lowers the chances of needle breakage by 500%
- ✓ New RED DOT on the needle hub marks the needle bevel position, even when the needle point is not visible.
- ✓ Years of exacting experience in the production of hypodermic needles has been applied to the production of Dental Needles, virtually painless, atraumatic, and perfectly sharp to give maximum patient comfort. Dental Needle production is computer controlled in all processes from manufacture to inspection. In addition, every needle passes an optical inspection.
- ✓ The cannula is siliconized.
- ✓ Needles are sterilized by Ethylene Oxide and their sterility is guaranteed by testing every production lot prior to release.
- ✓ Dental Needle hubs and boxes are color coded by gauge for easier identification of suitable needle and gauge.
- ✓ Each needle is individually packaged, sterilized, and ready for immediate use.
- ✓ Self-tapping ribs placed on the outside of the hub, and inside threads make for ease of use.
- ✓ Larger cannula lumen (.0055")

DENTAL NEEDLES PLASTIC HUB

Catalog No.	Description	Length	Hub Color
26555	30G Short	(21mm)	Blue
26562	30G x Long	(32mm)	Blue
26557	27G x Long	(32mm)	Yellow

100/box 1,000/case

**Convenient
RED DOT
marks the
bevel position**

**NEW
Hub design
for greater needle
flexibility**

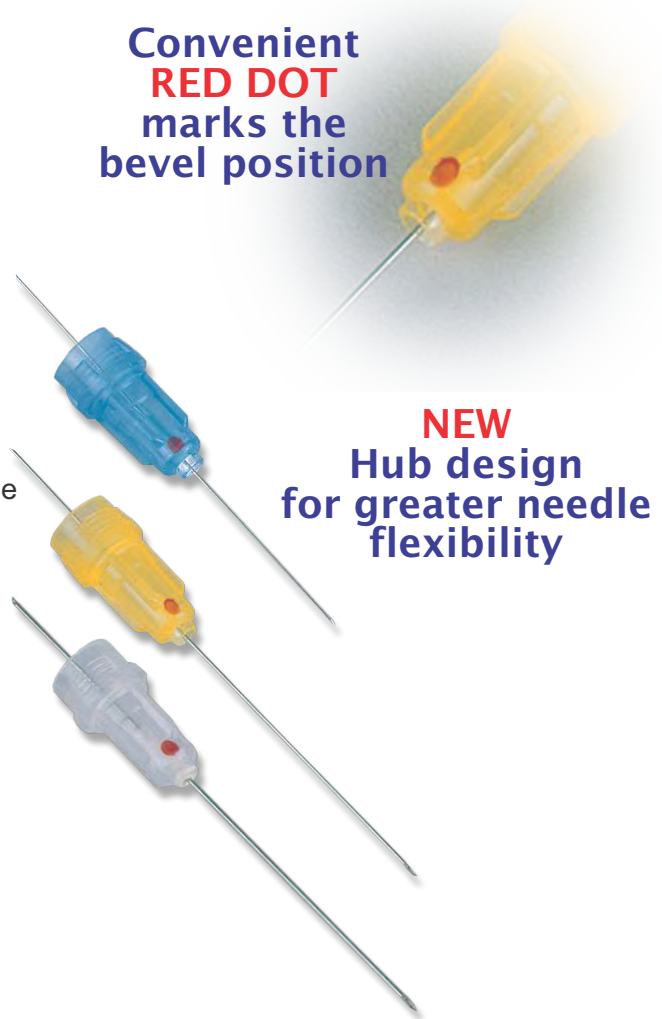

SPINAL NEEDLES



- ✓ This product does not contain Natural Rubber Latex
- ✓ Convenient blister packaging
- ✓ Non-Pyrogenic
- ✓ Transparent plastic hub
- ✓ Siliconized for smooth comfortable penetration



'QUINKE' BEVEL SPINAL NEEDLES

Catalog No.	Description	Hub Color
26960	18G x (1.20mm) x 3½"	Pink ■
26964	20G x (0.90mm) x 3½"	Yellow ■
26965	22G x (0.70mm) x 2¾"	Black ■
26967	22G x (0.70mm) x 3½"	Black ■
26970	25G x (0.50mm) x 3½"	Orange ■

50 / box 100 / case

SURGICAL BLADES DISPOSABLE SCALPELS



- ✓ This product does not contain Natural rubber latex
- ✓ Sterile, Non-Toxic, Non-Pyrogenic.
- ✓ Made from premium quality Swiss carbon Steel and Stainless Steel
- ✓ Computer controlled grinding, sharpening and polishing, ensures consistency smooth incision properties
- ✓ Sterilized by GAMMA radiation 2.5 - RADS
- ✓ A Vapor Corrosion Inhibitor (VCI) paper lining, leakage testing, and an aluminum foil peel pack help ensure quality and integrity when ready for use
- ✓ Each production lot is sampled and conforms to ISO 2859, Inspection level (S4) AOL 1.0 & 2.5
- ✓ Blade rigidity is tested to eliminate blade breakage
- ✓ Blade are ultrasonically cleaned prior to packing



STAINLESS STEEL SURGICAL BLADES	
Catalog No.	Size
29500	10
29502	11
29508	15
29515	22
100/box 1,000/case	

CARBON STEEL SURGICAL BLADES	
Catalog No.	Size
29526	11
29532	15
100/box 1,000/case	

STAINLESS STEEL DISPOSABLE SCALPELS	
Catalog No.	Size
29550	10
29552	11
29556	15
29559	22
10/box 100/case	



PRESSURE BANDAGES

ZorBand[®] PRESSURE BANDAGES



Absorbent cellulose pad expands on contact

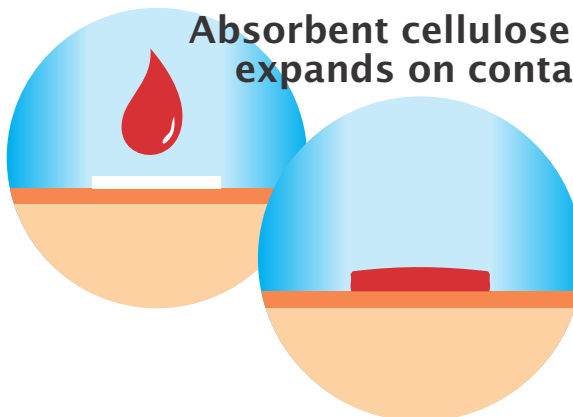

- ✓ This device does not contain natural rubber latex.
- ✓ Sterile, Non-Toxic, Non-Pyrogenic.
- ✓ Safe
- ✓ Increased efficiency
- ✓ Individually packaged
- ✓ More convenient than traditional dressings
- ✓ ZorBand reduces direct pressure time by over 40%
- ✓ Absorbent cellulose pad expands when contacted by blood
- ✓ Swelling action of pad creates a pressure compress
- ✓ Firmly applies pressure to puncture
- ✓ ZorBand tightly binds to patients' skin to guard from leakage and maintain pressure

PRESSURE BANDAGES

Catalog No.	Description
-------------	-------------

26836	X-Large
-------	---------

100/box, 1,000/case	
---------------------	--

DISPOSABLE DERMAL BIOPSY PUNCH



- ✓ Sterile, Non-Toxic
- ✓ Non-Pyrogenic
- ✓ Stainless Steel
- ✓ Variety of sizes available
- ✓ Sharp Rounded Blade Tip
- ✓ Round Plastic Handle with Ribbed Grip
- ✓ This product does not contain Natural Rubber Latex



DISPOSABLE DERMAL BIOPSY PUNCH	
with sharp rounded blade tip	
Catalog No.	Description
29560	1.0mm
29561	1.5mm
29562	2.0mm
29563	2.5mm
29564	3.0mm
29565	3.5mm
29566	4.0mm
29567	5.0mm
29568	6.0mm
29569	7.0mm
29570	8.0mm
50/box 300/case	

DISPOSABLE DERMAL CURETTE



- ✓ This product does not contain Natural Rubber Latex
- ✓ Sterile
- ✓ Non-Toxic
- ✓ Non-Pyrogenic
- ✓ Round Circular Tip
- ✓ Dynamic Grip
- ✓ Variety of Sizes Available
- ✓ Stainless Steel



DISPOSABLE DERMAL CURETTE	
With Round Circular Tip	
Catalog No.	Description
29580	2.0mm
29581	3.0mm
29582	4.0mm
29583	5.0mm
29584	7.0mm
50/box 300/case	

PRODUCT SPECIFICATIONS

PRODUCT	QUANTITY WEIGHT			INCHES			MILLIMETER		
	PCS	LBS	KGS	LENGTH	WIDTH	HEIGHT	LENGTH	WIDTH	HEIGHT
1/2-1mL U-40 / Insulin	500	4.82	2.19	17	7	6	432	178	152
1mL Insulin	500	5.36	2.43	17	7	6	432	178	152
0.3mL Insulin	500	4.50	2.04	17	7	6	432	178	152
1mL TB 0 Dead - Space	500	5.38	2.44	17	7	7	432	178	178
1mL TB w/needle	1000	14.50	6.58	23	16	10	584	406	254
1mL TB Only	1000	11.50	5.22	19	13	10	483	330	254
1mL LL Syringe w/ Safety Needle	300	5.34	2.42	16	10	8	406	254	203
1mL LL Syringe w/ Safety Needle	2000	22.80	10.34	26	17	17	660	432	432
Allergy Syringes	1000	9.00	4.08	13	12	11	330	305	279
3mL w/Needle	1000	16.45	7.46	28	16	9	711	406	229
3mL only	1000	14.30	6.49	28	12	11	711	305	279
3mL Syringe w/ Safety Needle	400	9.00	4.08	16	10	16	406	254	406
5-6mL w/needle	800	17.60	7.98	27	16	9	686	406	229
5-6mL only	800	15.20	6.89	18	15	12	457	381	305
10-12mL w/needle	800	26.40	11.97	30	18	12	762	457	305
10-12mL only	800	21.80	9.89	30	14	12	762	356	305
20-25mL only	500	26.65	12.09	28	16	15	711	406	381
Curved Tip Syringe	500	13.10	5.94	20	12	9	508	305	229
30-35mL only	250	17.65	8.01	31	15	10	787	381	254
50-60mL only	150	15.60	7.08	18	17	13	457	432	330
Scalp Vein Set Butterfly	500	7.00	3.18	18	12	10	457	305	254
Safety Scalp Vein Set	500	8.00	3.63	21	10	10	533	254	254
Safety Blood Collection Set	200	4.70	2.13	11	9	9	279	229	229
IV Catheter	1000	3.30	1.50	11	6	6	279	152	152
Hypodermic Needles	2000	6.55	2.97	17	14	5	432	356	127
Hypodermic Needles (Safety)	1000	7.70	3.49	17	14	8	432	356	203
Dental Needles	1000	4.82	2.19	11	7	7	279	178	178
Multi-Sample Needle	1000	4.60	2.09	16	7	4	406	178	102
Luer Adapter	1000	5.37	2.44	11	7	7	279	178	178
Luer Lock Holders Pre-Attached	1000	4.65	2.11	12	11	10	305	279	254
Luer Holder	1000	6.30	2.86	15	13	12	381	330	305
Spinal Needle	100	1.70	.77	8	6	6.5	203	152	165
IV Administration Set	50	4.31	1.95	15	9	8	381	229	203
IV Extension Set (case of 100)	100	2.58	1.34	10	8	8	254	203	191
IV Extension Set (case of 60)	60	2.15	.97	12	8	4	292	203	102
Huber Needles	50	0.22	0.10	8	4	3	203	102	76
Safety Huber Infusion Set	20	0.85	0.39	12	6	4	305	152	102
Surgical Blades	1000	2.74	1.24	8	7	3	203	178	76
Disposable Scalpels	100	2.48	1.12	10	9	4	254	229	102
Injection Plugs w/cap	200	1.56	0.71	12	8	3	305	203	76
Zorband	1000	2.30	1.04	8	7	6	203	178	152
Aluminum Hub Blunt Needles	100	1.00	0.45	8	3	2	203	76	51
Disposable Dermal Curette	300	11.02	5.0	18	15	6	445	390	140
Disposable Dermal Biopsy Punch	300	6.61	3.0	14	14	7	365	350	170

Specifications vary slightly between sizes.

Packaging subject to change.

Please contact us for information on products not listed here.

EXELINT INTERNATIONAL, CO.

Corporate Headquarters

2500 Santa Fe Avenue

Redondo Beach

California 90278 USA

Phone: (310) 649-0707

Fax: (310) 649-1178

Email: info@exelmed.com

FOR INFO PLEASE CALL

1-800-940-EXEL(3935)

info@exelint.com

www.exelint.com